

NorthWind

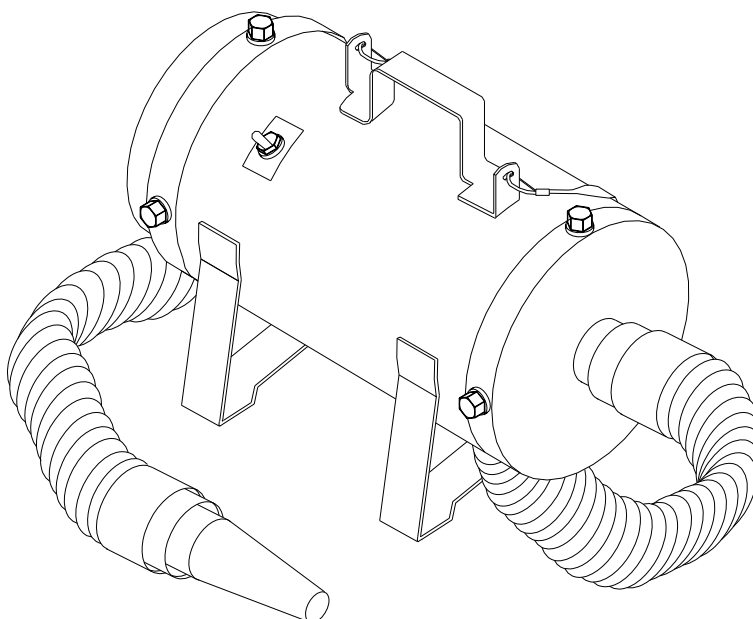

MODELS: NWB
86284220

Operating Instructions (ENG)



Read instructions before operating the machine.

MACHINE DATA LOG

| |
|---|
| MODEL _____ |
| DATE OF PURCHASE _____ |
| SERIAL NUMBER _____ |
| SALES REPRESENTATIVE # _____ |
| Copyright 2004 Windsor Industries, Printed in USA |

| |
|----------------------------|
| YOUR DEALER |
| Name: _____ |
| Address: _____ |
| Phone Number: _____ |

TABLE OF CONTENTS

Machine Data Log.....2
Table of Contents.....3

HOW TO USE THIS MANUAL

How to use this Manual..... 1-1

SAFETY

Important Safety Instructions2-1
Hazard Intensity Level.....2-2

OPERATIONS

Technical Specifications..... 3-1
Notes..... 3-1
Controls/Components..... 3-2
Maintenance..... 3-2

PARTS LIST

Spare Parts List.....4-1
Warranty.....4-2

HOW TO USE THIS MANUAL

This manual contains the following sections:

- HOW TO USE THIS MANUAL
- SAFETY
- OPERATIONS
- PARTS LIST

The HOW TO USE THIS MANUAL section will tell you how to find important information for ordering correct repair parts.

Parts may be ordered from authorized Windsor dealers. When placing an order for parts, the machine model and machine serial number are important. Refer to the MACHINE DATA log which is filled out during the installation of your machine. The MACHINE DATA log is located on the inside of the front cover of this manual.

| |
|--|
| MODEL _____ |
| DATE OF PURCHASE _____ |
| SERIAL NUMBER _____ |
| SALES REPRESENTATIVE # _____ |
| <small>Copyright 2004 Windsor Industries, Printed in USA</small> |

The serial number of your machine is located just below the handle on the cord side.

The SAFETY section contains important information regarding hazard or unsafe practices of the machine. Levels of hazards is identified that could result in product or personal injury, or severe injury resulting in death.

The OPERATIONS section is to familiarize the operator with the operation and function of the machine.

The PARTS LIST section contains assembled parts illustrations and corresponding parts list. The parts lists include a number of columns of information:

- **REF** – column refers to the reference number on the parts illustration.
- **PART NO.** – column lists the part number for the part.
- **PRV NO.** - Reference No.
- **QTY** – column lists the quantity of the part used in that area of the machine.
- **DESCRIPTION** – column is a brief description of the part.
- **SERIAL NO. FROM** – If this column has an (*) and a Reference number, see the SERIAL NUMBERS page in the back of your manual. If column has two asterisk (**), call manufacturer for serial number. The serial number indicates the first machine the part number is applicable to. The main illustration shows the most current design of the machine. When a boxed illustration is shown, it displays the older design.
- **NOTES** – column for information not noted by the other columns.

NOTE: If a service or option kit is installed on your machine, be sure to keep the **KIT INSTRUCTIONS** which came with the kit. It contains replacement parts numbers needed for ordering future parts.

NOTE: The number on the lower left corner of the front cover is the part number for this manual.

IMPORTANT SAFETY INSTRUCTIONS

When using an electrical appliance, basic precaution must always be followed, including the following:

READ ALL INSTRUCTIONS BEFORE USING THIS MACHINE.



To reduce the risk of fire, electric shock, or injury:

Use only indoors. Do not use outdoors or expose to rain.

Use only as described in this manual. Use only manufacturer's recommended components and attachments.

If the machine is **not working properly**, has been dropped, damaged, left outdoors, or dropped into water, return it to an authorized service center.

Do not operate the machine with any openings blocked. Keep openings free of debris that may reduce airflow.

Machine can cause a fire when operating near flammable vapors or materials. Do not operate this machine near flammable fluids, dust or vapors.

This machine is suitable for commercial use, for example in hotels, schools, hospitals, factories, shops and offices for more than normal housekeeping purposes.

Maintenance and repairs **must be done** by qualified personnel.

The machine shall only be operated by instructed and authorized persons.

Do not handle the plug or machine with wet hands.

Do not unplug machine by pulling on cord. To unplug, grasp the plug, not the cord.

Do not use with damaged cord or plug. Follow all instructions in this manual concerning grounding the machine.

Do not pull or carry by cord, use cord as a handle, close a door on cord, or pull cord around sharp edges or corners.

Do not pull/run machine over cord. **Keep** cord away from heated surfaces.

Connect to a **properly** grounded outlet. See Grounding Instructions.

Do not allow to be used as a toy. Close attention is necessary when used near children.

Do not leave the appliance when plugged in. Unplug from outlet when not in use or before servicing.

Turn off all controls before unplugging.

SAVE THESE INSTRUCTIONS

HAZARD INTENSITY LEVEL

The following symbols are used throughout this guide as indicated in their descriptions:

HAZARD INTENSITY LEVEL

There are three levels of hazard intensity identified by signal words -**WARNING** and **CAUTION** and **FOR SAFETY**. The level of hazard intensity is determined by the following definitions:



WARNING - Hazards or unsafe practices which COULD result in severe personal injury or death.



CAUTION - Hazards or unsafe practices which could result in minor personal injury or product or property damage.

FOR SAFETY: To Identify actions which must be followed for safe operation of equipment.

Report machine damage or faulty operation immediately. Do not use the machine if it is not in proper operating condition. Following is information that signals some potentially dangerous conditions to the operator or the equipment. Read this information carefully. Know when these conditions can exist. Locate all safety devices on the machine. Please take the necessary steps to train the machine operating personnel.

FOR SAFETY:

DO NOT OPERATE MACHINE:

Unless Trained and Authorized.

Unless Operation Guide is Read and understood.

In Flammable or Explosive areas.

In areas with possible falling objects.

WHEN SERVICING MACHINE:

Avoid moving parts. Do not wear loose clothing; jackets, shirts, or sleeves when working on the machine. Use Windsor approved replacement parts.

GROUNDING INSTRUCTIONS

THIS PRODUCT IS FOR COMMERCIAL USE ONLY.

ELECTRICAL:

In the USA this machine operates on a standard 15 amp 115V, 60 hz, A.C. power circuit. The amp, hertz, and voltage are listed on the data label found on each machine. Using voltages above or below those indicated on the data label will cause serious damage to the motors.

EXTENSION CORDS:

If an extension cord is used, the wire size must be at least one size larger than the power cord on the machine, and must be limited to 50 feet (15.5m) in length.

GROUNDING INSTRUCTIONS:

This appliance must be grounded. If it should malfunction or break down, grounding provides a path of least resistance for electric current to reduce the risk of electric shock. This appliance is equipped with a cord having an equipment-grounding conductor and grounding plug. The plug must be inserted into an appropriate outlet that is properly installed and grounded in accordance with all local codes and ordinances.

This appliance is for use on a nominal 120-volt circuit, and has a grounded plug that looks like the plug in "Fig. A". A temporary adaptor that looks like the adaptor in "Fig. C" may be used to connect this plug to a 2-pole receptacle as shown in "Fig. B", if a properly grounded outlet is not available. The temporary adaptor should be used only until a properly grounded outlet (Fig. A) can be installed by a qualified electrician. The green colored rigid ear, lug, or wire extending from the adaptor must be connected to a permanent ground such as a properly grounded outlet box cover. Whenever the adaptor is used, it must be held in place by a metal screw.

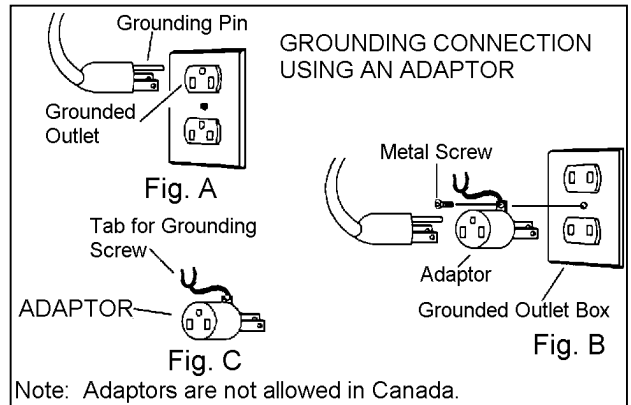

Improper connection of the equipment-grounding conductor can result in a risk of electric shock. Check with a qualified electrician or service person if you are in doubt as to whether the outlet is properly grounded. Do not modify the plug provided with the appliance - if it will not fit the outlet, have a proper outlet installed by a qualified electrician.

TECHNICAL SPECIFICATIONS

| ITEM | DIMENSION/CAPACITY |
|---|---------------------------|
| Electrical | 115Volt, 9.5 Amps, 60Hz |
| Electric Vacuum Motor | Single Two Stage |
| Dimensions – Weight (with filter and hose assembly) | 13 lbs (5.9 kg) |
| Dimensions – Length (W/O filter and hose assembly) | 12 in. (30.5 cm) |
| Dimensions - Height | 11.5 in. (29.2 cm) |
| Dimensions - Width | 8.5 in. (21.6 cm) |
| Power Cable | 9.5 ft. (2.4 m) |

NOTES:

CONTROLS/COMPONENTS/MAINTENANCE

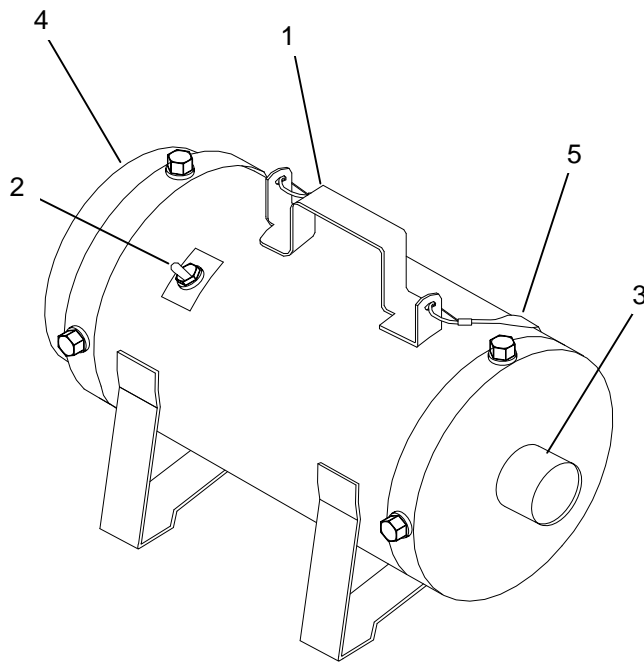

DAILY/REGULAR MAINTENANCE

Before making any adjustments or repairs to the machine, disconnect the power cord from electrical source.

Inspect all hoses, electrical cables and connections on your machine. Frayed or cracked hoses should be repaired or replaced to eliminate pressure loss. If the cable insulation is broken or frayed, repair or replace it immediately. Do not take chances with electrical fire or shock.

Remove lint, dirt or debris build-up from filter. This will give your motor added life. Added build-up may decrease blower performance and/or damage your motor.

CONTROLS/COMPONENTS

1. **Main Handle.** Used to carry and move machine.
2. **Power Switch.** Turns on blower motor.
3. **Blower Port.** Directs flow into Hose assembly.
4. **Filter.** Keeps debris from the motor, facilitates easy cleaning.
5. **Shoulder Strap.**

SPARE PARTS LIST

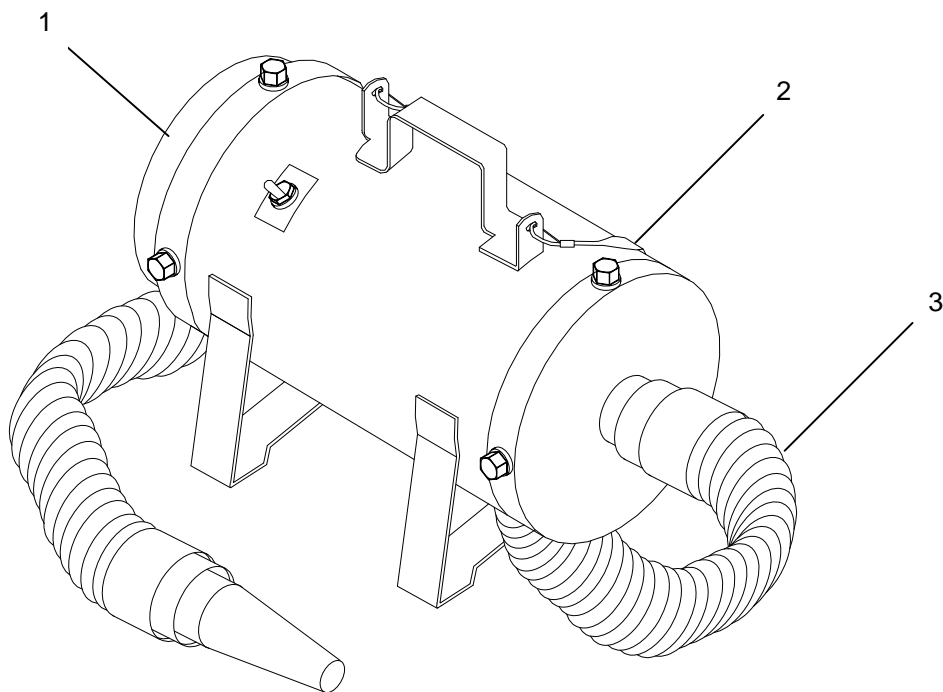

| REF | PART NO. | PRV NO. | QTY | DESCRIPTION | SERIAL NO. FROM | NOTES: |
|-----|----------|---------|-----|-------------------------|--------------------|-----------|
| 1 | 86161330 | 34423 | 1 | FILTER, NWB | | |
| 2 | 86161350 | 730287 | 1 | STRAP ASM, NWB COMPLETE | | |
| 3 | 86161340 | 39701 | 1 | HOSE ASM, NWB COMPLETE | | |
| 4 | 86244120 | 500848 | 1 | LABEL, NORTHWIND | | NOT SHOWN |



WINDSOR INDUSTRIES

North American New Machine Warranty

Effective on all products shipped *AFTER* July 31, 2007

Limited Warranty

Windsor Industries warrants new machines against defects in material and workmanship under normal use and service to the original purchaser. Any statutory implied warranties, including any warranty of merchantability or fitness for a particular purpose, are expressly limited to the duration of this written warranty. Windsor will not be liable for any other damages, including but not limited to indirect or special consequential damages arising out of or in connection with the furnishing, performance, use or inability to use the machine. This remedy shall be the exclusive remedy of the buyer. The warranty period is subject to the conditions stated below.

10 / 3 Warranty: 10 Years Polyethylene (PE) Housings, 3 Years Parts, and Service Labor

Subject to conditions outlined below, Windsor Industries warrants rotationally molded PE housings and parts on all of its machines to be free from defects in material and workmanship, under normal use and service for ten (10) years to the original owner.

Under this warranty we guarantee the performance of non-polyethylene parts and components to be free from defects for up to three (3) years or up to 2,500 hours of operation, whichever comes first, to the original end user. Parts replaced or repaired under this warranty are guaranteed for the remainder of the original warranty period. (See table below)

Service labor charges are covered for up to three (3) years or up to 2,500 hours of operation, whichever comes first, from the date of purchase through authorized Windsor service provider. No travel coverage is extended for cord-electric models. See table below for each general product model warranty coverage.

| Product | PE Housing & Parts | Non- PE Parts | Service Labor | Travel |
|--|--------------------|-----------------------|-----------------------|----------|
| Rider / Stand up Scrubbers | 10 years | 3 years or 2000 hours | 3 years or 2000 hours | 6 Months |
| Rider Sweepers | 10 years | 3 years | 3 years | 6 Months |
| Walk Behind Scrubbers | 10 years | 3 years or 2500 hours | 3 years or 2500 hours | 6 Months |
| Walk Behind Sweepers | 10 years | 3 years | 3 years | 6 Months |
| Battery Burnishers | 10 years | 3 years | 3 years | 6 Months |
| Extractors / Compass | 10 years | 3 years | 3 years | - |
| Polishers / Elec. Burnishers / GH/iCapsol Mini | 10 years | 3 years | 3 years | - |
| Wide Areas Vacuums | 10 years | 3 years | 3 years | - |
| VacPak Vacuums | 10 years | 1 year | 1 year | - |
| Tracer/Flex Sweepers/Scrubbers | 10 years | 3 year | 3 months | 90 days |
| Air Movers / Dri-matic / TITAN™ /Rombus/Priza | 1 year | 1 year | 1 year | - |
| Canister Vacuum | 1 year | 1 year | 1 year | - |
| Wet/Dry Vacuum | 1 year | 1 year | 1 year | - |
| Broom | 1 year | 1 year | 1 year | - |
| Steamer | 1 year | 1 year | 1 year | - |
| Propane Burnishers / Strippers | - | 2 year | 1 year | - |

| | | |
|---------------------------|---|--------------------------------|
| VERSAMATIC® / FLEXAMATIC® | Brush motor, Vacuum motor, Belts, Swivel Neck – 3 years | All other parts/Labor – 1 year |
| SENSOR® | Vacuum motor, Belts – 2 years | All other parts/Labor – 1 year |

Product exceptions and Exclusions:

- Extractor brush motors, **ALL** pump motors, **ALL** PC boards and electronics, **ALL** Vacuum motors (other than VERSAMATIC®, SENSOR® and FLEXAMATIC®), **ALL** pumps, and diaphragms/Tank bags carry a one (1) year parts and service labor warranty.
- The Eagle-Robin® engines have three (3) year manufacturer's warranty. The Honda® and Kawasaki® engines have two (2) year manufacturer's warranty. **NOTE:** The engine warranty is administered through the engine manufacturer and must be repaired at an authorized service center.

Windsor Industries reserves the right to change its warranty policy without notice



WINDSOR INDUSTRIES
North American New Machine Warranty
Effective on all products shipped *AFTER* July 31, 2007

Normal wear items and accessories including, but not limited to, belts, brushes, FLEXAMATIC® foot pedal, capacitors, carbon brushes, casters, clutches, cords, filters, finishes, gaskets, hoses, light bulbs, rectifiers, switches, squeegees, bearings, pulleys, relays, actuating cables, wheels, tires, and propane tanks will be warranted for manufacturing defects for 90-days from the purchase date.

The warranty commences on the purchase date by the original end user from an authorized Windsor agent, subject to proof of purchase. The Machine Registration Card must be completed and returned immediately at the time of purchase. If proof of purchase cannot be identified, the warranty start date is 90 days after the date of sale to an authorized Windsor distributor. Parts replaced or repaired under warranty are guaranteed for the remainder of the original warranty period.

90 Day Warranty Extension Available

Upon receipt of the Machine Registration Card, Windsor will extend by 90 days, from the date of purchase, all items included under the one-year provision. This applies only to one-year items and does not include 90-day wear items.

This Warranty Shall Not Apply To:

1. Any product that has been subject to abuse, misuse, neglect or unauthorized alteration (including the use of incompatible or corrosive chemicals or overloading of capacity).
2. Products that have experienced shipping or freight damage.
3. Repairs necessary to correct any failure due to improper pre-delivery service and inspection by the selling dealer.
4. Excessive time for cleaning units in preparation for repair.
5. Any repairs resulting from poor initial service work or improper diagnosis.
6. Tune-up parts such as plugs, plug wires and condensers.
7. Any design alterations performed by an organization not authorized or specified by Windsor.
8. Battery and charger warranties are handled directly with the manufacturer (Trojan® batteries and Lester® chargers).
9. High-pressure washing.
10. Electrical components exposed to moisture.

If difficulty develops during the warranty period, contact the authorized Windsor agent from whom the product was purchased. Windsor Industries may elect to require the return of components to validate a claim. Any defective part to be returned must be shipped freight prepaid to an authorized Windsor Distributor/Service Center or to the Windsor factory.

Use Of Parts Not Approved By Windsor Industries Will Void All Warranties

This warranty is valid only for all products Shipped/Sold *AFTER* July 31, 2007. A product sold before that date shall be covered by the limited warranty in effect at the date of sale to the original purchaser.